



서울시립대학교
UNIVERSITY OF SEOUL

Exchange Partner Information

For regular semester's student exchange program

Name: University of Seoul

Country: Republic of Korea (South Korea)

Contact person: UOS coordinators by region

• Primary Contact Persons for Exchange Students exchangein@uos.ac.kr / exchangeout@uos.ac.kr			
	Contact Person	Responsibilities	Contact Details
Outbound (UOS students) & Mobility Balance & Agreements	Ms. Eunhwa SHIN (Head)	ISEP & North America	Tel: +82-2-6490-6658 Email: eunhwashin@uos.ac.kr
	Ms. Heewon PARK	Asia, Middle & South America Short-term Study Abroad Program	Tel: +82-2-6490-6665 Email: kor1hee1@uos.ac.kr
	Ms. Claire LEE	Europe & Australia Global Internship	Tel: +82-2-6490-6661 Email: imnylee17@uos.ac.kr
Inbound (Int'l students)	Ms. Jean SONG (Head of Inbound Exchange)	ISEP & All regions (except Greater China) Seoul International Summer School	Tel: +82-2-6490-6657 Email: jeanss@uos.ac.kr
	Ms. Jooyeon KIM	Greater China Int'l & GKS Admissions (Undergraduates)	Tel: +82-2-6490-6660 Email: nori14@uos.ac.kr
	Mr. Sangseop EOM	Seoul International Summer School Seoul Mate Int'l & GKS Admissions (Graduates)	Tel: +82-2-6490-6659 Email: eoms21@uos.ac.kr
	Mr. Jongtak KIM	Int'l Student Management (Admission & Visa Issuance) Global Lounge	Tel: +82-2-6490-6654 Email: kjongtagi@uos.ac.kr

Fax: +82-2-6490-6664

Address: 163 Seoulsiripdae-ro, Dongdaemun-gu, Seoul, Republic of Korea 02504

Useful Websites for Exchange Students: <http://global.uos.ac.kr> & <http://www.visitkorea.or.kr>

Semester Dates

Spring Semester, 2019(E)

Fall Semester, 2019(E)

	Spring Semester, 2019(E)	Fall Semester, 2019(E)
Dorm Check-in (from 3pm)	From February 27, 2019	From August 27, 2019
Orientation	February 28, 2019	August 30, 2019
Classes start / end	March 4, 2019 / June 21, 2019	September 2, 2019 / December 20, 2019
Vacation (Winter/ Summer)	June 22, 2019 – August 31, 2019	December 23, 2019 – February 29, 2020
Exams	Mid-term in April, Final in June	Mid-term in September, Final in December
Dorm Check-out (by 12pm)	June 22, 2019 *extension possible(only monthly) upon request	December 21, 2019 *extension possible(only monthly) upon request
Nomination Deadline	October 15, 2018	April 15, 2019
Application Deadline	October 31, 2018	April 30, 2019
Admission Issue	Early December	Early June
Nomination Process	<ul style="list-style-type: none"> - The international offices of UOS partner universities are required to nominate candidate(s) via the following site: http://global.uos.ac.kr/iice/nomination/write.do - Reference: IICE website (http://global.uos.ac.kr) → For International Students → Studying in UOS → Nomination 	
Application Process	<ul style="list-style-type: none"> - Nominated students are required to complete UOS online application via the following site: http://global.uos.ac.kr/iice/study/prProcess.do - Reference: IICE website (http://global.uos.ac.kr) → For International Students → Studying in UOS → Student Exchange Program → Eligibility & Application Process - What to submit on arrival at the orientation; <ol style="list-style-type: none"> (1) One official photo (3.5cm x 4.5cm, full color with white background) (2) Copy of insurance 	
<p>All the dates for Academic Year 2019 are tentative* as of November 1, 2018. If there is any change, it will be notified accordingly.</p> <p>*Academic Schedule for 2019Y will be completed in November, 2018.</p>		

Academics

< Language >

Courses given in which language(s)	<p>Mostly Korean, but some of classes be lectured in English</p> <p>* List of the courses offered in English: refer to the IICE website => http://global.uos.ac.kr/iice/study/prEnglish.do</p> <p>* The final course list can be found a month before each semester starts.</p> <p>We cannot guarantee the courses your students would like to take.</p>
Language requirements (i.e. TOEFL scores)	N/A
Language courses	<p>Korean language courses available <u>free of charge</u></p> <p>- 3 levels of Korean Language courses will be offered Beginning Korean, Intermediate Korean, Advanced Korean Language</p> <p>- Specific Korean Language course list will be informed early February and August.</p>

<Graduate School>

Does UOS accept international graduate students to graduate school as non-degree short-term exchange students?	<p><input checked="" type="checkbox"/> Yes <input type="checkbox"/> No</p> <p>* However, all the courses offered at graduate level are taught in Korean. For the graduate students who are not fluent in Korean is strongly advised to be enrolled to undergraduate program. In this case, the student should ask his/her study abroad coordinator at the home university if this option would be accepted according to the university's policy.</p>
--	--

< Others >

Conditions for choosing academic programs	Most of the departments or schools of UOS welcome exchange students. However, it is strongly recommended for exchange students to apply to their field of studies.
Recommended credit points per semester	<p>15 credits</p> <p>* Most of each course is equivalent to 3 credits.</p> <p>* 1 credit = 15 class hours</p> <p>* A student should take at least 6 credits and can take up to 20 credits.</p>
Grading System	<p>A+:95-100 A0:90-95 B+:85-89 B0:80-84 C+:75-79 C0:70-74</p> <p>D+:65-69 D0:60-64 F (fail): below 60</p>
Course Registration	<p>UOS Course Registration System (UOSCRS) for international exchange student - http://wise.uos.ac.kr/uosdoc/ucr.UcrIntchTlsnLogin.serv</p> <p>Students are required to do online course registration via UOSCRS and detailed information will be announced early February and early August.</p> <p>* Course List is available only a month before each semester starts (early February/early August). UOS regional coordinators contact to each student as soon as course list completed.</p>

Housing

On-campus Housing	<ul style="list-style-type: none"> - UOS only secure/guarantee on-campus housing <u>only for those exchange students whose universities secure/guarantee on-campus housing for UOS students.</u> - ISEP students are assigned to stay on-campus housing (only in Residence Hall)
Off-campus Housing	<ul style="list-style-type: none"> - UOS recommends several off-campus housings to the students (open for all)

*UOS do not secure on-campus housing to all partner universities for dormitory room shortage. The condition for on-campus housing guarantee is as above. Please confirm with your home university coordinator your housing option before complete UOS online application.

<On-campus Housing>

Room Type of Residence Hall	<p>Each room of double occupancy, 15 rooms on each of the 7 floors</p> <ul style="list-style-type: none"> - Shower room, Toilet, and Laundry are shared. - Extension possible during vacations. <p>Fees: 560,000 won/semester + 100,000 won deposit = 660,000 won</p> <ul style="list-style-type: none"> * Fees for vacation (about 2 months): 280,000 won * Application for vacation: right before each semester ends
Room Type of International House	<p>Each unit with 2 rooms / 3 rooms / 4 rooms of single occupancy</p> <ul style="list-style-type: none"> - Living room, Shower room, Toilet, and Laundry are shared. - Extension possible during vacations. <p>Fees: 800,000 won/semester + 100,000 won deposit = 900,000 won</p> <ul style="list-style-type: none"> * Fees for vacation (about 2 months): 400,000 won * Application for vacation: right before each semester ends
Remarks	<p>In both housings, male and female sections are segregated.</p> <p>Allocation will be done on random basis.</p> <p>Curfew between 3 a.m. and 5 a.m.</p> <p>Fees are payable on arrival at UOS.</p> <p>Deposit will be refunded after the fees for usage of facilities are deducted.</p>
How to apply	<p>You will have applied it already through the UOS on-line application system.</p> <ul style="list-style-type: none"> * Due to lack of International House rooms, most of exchange students will be arranged at Residence Hall. UOS scholarship recipients are automatically assigned to Residence Hall.
<p>All the fees and the conditions above are for the Academic year of 2018. If there is any change, it will be notified accordingly.</p>	

<Residence Hall – Room type>

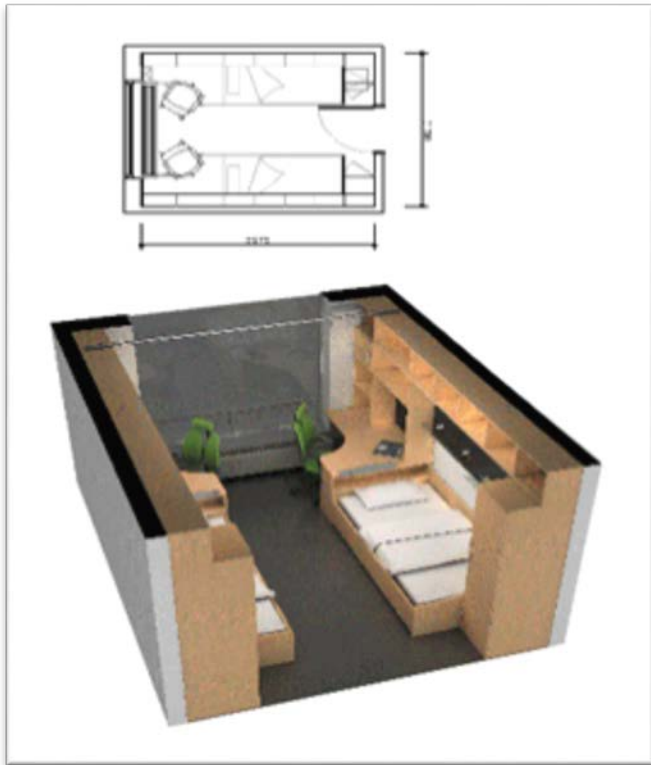

<International House – Room type>



<Off-campus Housing>

URSeoul	<p>Each room of double or triple occupancy, - Shower room, Toilet, and Laundry are shared.</p> <p>A. Twin Standard : 570,000 KRW per month (for 1 person) B. Twin Superior : 610,000 KRW per month (for 1 person) C. Twin Deluxe : 650,000 KRW per month (for 1 person) D. Twin Suite : 680,000 KRW per month (for 1 person) E. Triple room : 465,000 KRW per month (for 1 person)</p> <p>- Deposit : one month rent fee</p> <p>No Curfew</p> <p>For more information, please visit to http://urseoul.com/</p> <p>Just 5 min walk from Seoul Station and 23 min from URSeoul to UOS campus by metro.</p> <p>Inquires & apply : info@urseoul.com</p>
CMS Inn	<p>Each room of double occupancy, - Private toilet, Air conditional, Refrigerator, TV, Wardrobe, Free WIFI, laundry</p> <p>A. Sing Room(1person) : 950,000 KRW per month B. Twin Room(2persons) : 550,000 KRW per month (for 1 person)</p> <p>- Deposit 100, 000KRW</p> <p>- Breakfast and all utilities are included</p> <p>No Curfew</p> <p>For more information, please visit to www.cmsinn.com</p> <p>5 min walk from Hoegi station and 20 min walk from UOS campus.</p> <p>Inquires & apply : cms.inn.seoul@gmail.com</p>
<p>All the fees above are for the Academic year of 2018. If there is any change, it will be notified accordingly.</p>	

Insurance & Certificate of Health

<p>Are there any insurance packages that students are required to purchase after arrival?</p>	<p><input type="checkbox"/> Yes <input type="checkbox"/> No <input checked="" type="checkbox"/> No, but proof of prior purchase required</p>
<p>Does Certificate of Health really need to be prepared before coming to Korea?</p>	<p><input checked="" type="checkbox"/> Yes <input type="checkbox"/> No</p> <p>* The Certificate of Health is required to be submitted at your online application. The form is downloadable from the on-line application webpage.</p>

Scholarship

Are there any scholarships offered by UOS for exchange students?	<input checked="" type="checkbox"/> Yes (conditional) <input type="checkbox"/> No If yes, how much is it? (200,000 KRW to 400,000 KRW per month) * Scholarship can be offered on condition that your home university provides similar benefits for UOS students in return. * The recipients should stay in Korea more than 15 days per month to receive this scholarship. * UOS scholarship is not provided during vacations (July&August / January&February). * The recipients should keep their good score at the UOS. If they fail to have at least over 2.5 overall 4.5, we are unable to provide the scholarship.
Scholarship for ISEP students	ISEP students benefit from UOS - Free on-campus housing (only Residence Hall available) * ISEP students are asked to pay refundable deposit on arrival by oneself - Monthly Stipend (400,000 KRW) will be provided as of meal plan * The recipients should stay in Korea more than 15 days per month to receive this scholarship. * Monthly Stipend is not provided during vacations (July&August / January&February) except one-year student.
Others	GKS(Global Korea scholarship) National Institute for International Education (NIIED) is offering GKS for exchange students studying at UOS. The GKS provides one-time settlement fee of 200,000KRW, a monthly stipend of 800,000KRW, and roundtrip airfare.

Others

Average cost of living per semester	700,000 won to 1,000,000 won per month *Including food, local transportation, books, entertainment, etc
UOS buddy system: “SeoulMate”	SeoulMate consists of UOS Korean students will join as volunteers to help you to adjust your life in UOS, Seoul and Korea. SeoulMate will contact you by email about a month before each semester starts.
Airport pick-up	Please refer to the following website. https://www.airport.kr/ap/en/qck/onlResInterTaxiRes.do
Websites for further local information about the city/town and university area	http://www.uos.ac.kr or http://global.uos.ac.kr
UOS’s location in Seoul	10km away from City Hall (North East Seoul)

Information above is as of November 1, 2018 and subject to change. All the changes will be informed accordingly.